

# 71" TANYA ACRYLIC FREESTANDING TUB

Cat. No.  
ATDRSN71RIG-XX



## Features:

- ▶ Acrylic construction for lighter weight
- ▶ Sleek contemporary design
- ▶ Drain and overflow covers included (available in 6 finishes)
- ▶ Rim measurement: 1-3/8"
- ▶ Overflow slot with integrated drain
- ▶ Drain included
- ▶ No faucet holes
- ▶ Includes build in adjusters
- ▶ Angle slope of tub: 29°
- ▶ Tub is thoroughly inspected before shipment
- ▶ Option to add insulation between tub walls available

## Finishes:

<b>WT</b>	White
<b>CP</b>	Polished Chrome
<b>BN</b>	Brushed Nickel
<b>PN</b>	Polished Nickel
<b>ORB</b>	Oil Rubbed Bronze
<b>PB</b>	Polished Brass

**Custom Colors Available** (inside of tub is always white enamel):  
Painted bathtubs are considered "special order" and are not returnable  
\$160 Bisque or Black \$250 Designer Color



L: 71"  
W: 31-1/8"  
H: 24" lowest, 27-1/4" highest

Water depth: 18-1/4" to top of tub  
Water depth: 15-1/8" to overflow  
Overflow hole diameter: 3" x 1/2"  
Center of drain to back of rim: 15-1/2"  
Bottom of drain to floor: 4-1/4"  
Bathing well to floor: 6"

The following is recommended for  
ATDRSN71RIG-WH:

- Faucets: part # 7082, or #7088
- Rigid, freestanding supplies: part #4502
- Freestanding filler: part #7902 or #7934  
(Supplies included with filler)



For easier installation we  
recommend use of 5598-ITD  
Easy Install Rough In Kit

Gallon Capacity: 67  
Shipping Weight: 142 lbs.  
Empty Weight: 82 lbs.  
Filled Weight: 642 lbs.

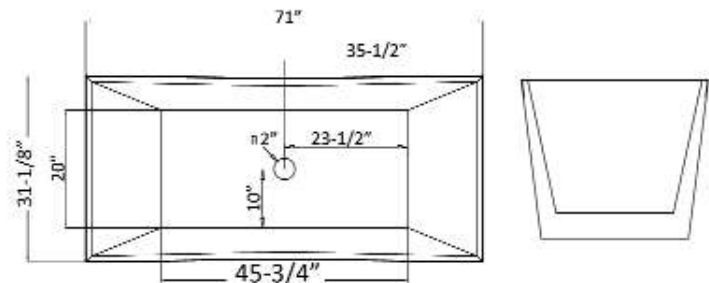
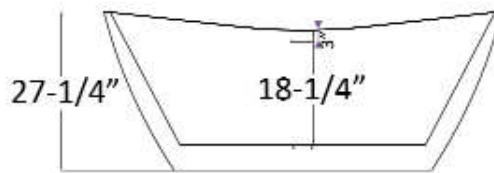

Dimensions of fixture are nominal and specifications subject to change without notice.